

**For Office Use Only**

Date: \_\_\_\_\_

Permit #: \_\_\_\_\_

Receipt #: \_\_\_\_\_

Amount: \_\_\_\_\_

Issued By: \_\_\_\_\_

# City Of Willowick

31230 Vine St. Willowick Oh 44095

## Residential Zoning Application

440-516-3000

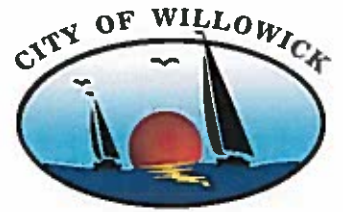

**Property Address:** \_\_\_\_\_

**Owners Name:** \_\_\_\_\_

**Phone No:** \_\_\_\_\_

**Owners Address:** \_\_\_\_\_

**City, State, Zip** \_\_\_\_\_

**Contractor:** \_\_\_\_\_

**Phone No:** \_\_\_\_\_

**Contractor Address:** \_\_\_\_\_

**City, State, Zip** \_\_\_\_\_

**Zoning Review Structure**

2 Sets construction drawings required

2 Site plans required

- New Residential Structure
- Single family
- Two Family
- Three Family
- Room Addition
- Attached Garage
- Interior Alteration
- Patio Enclosure
- Demolition
- Other \_\_\_\_\_

**Zoning Review Accessory Structure**

2 Sets construction drawings required

2 Site plans required

- Detached Garage
- Addition to Detached Garage
- Shed; >200 sq. ft.
- Gazebo
- Deck
- Swimming Pool
- Ramp
- Other \_\_\_\_\_

**Zoning Review Misc.**

2 Site Plans Required

- A/C Unit (rear yard only)
- Generator (rear yard only)
- Other \_\_\_\_\_

Estimated Cost \$ \_\_\_\_\_

All residential plumbing, electrical, building, gas piping and HVAC permits are to be obtained from the Lake County Building Department, 105 Main St., Bldg. B, Second Floor, Painesville OH 44077. Phone # 440-350-2636.

I state that I am the owner/agent of the subject property, have read and understand the contents of this application; and that all information contained in this application, attached exhibits and other information submitted is complete and in all respects true and correct, to the best of my knowledge and belief.

Property Owners / Agent Signature \_\_\_\_\_

Date \_\_\_\_\_

Print Name \_\_\_\_\_

**Office Use Only**

Approved Date: \_\_\_\_\_

Denied Reason \_\_\_\_\_

Variance Needed Reviewed By: \_\_\_\_\_

Chapter 751.08

Homeowner's Exception to Contractor Registration Requirements

...such work is actually performed by the property owner or members of the owner's immediate family, same being defined as the owner's spouse, child, grandchild, sibling or parent, and the work is performed without compensation. Any work performed by the property owner shall be subject to all of the provisions of the City Building Code and to all inspections required under the Code. (Ord. 74-36. Passed 5-20-74).

PLEASE NOTE-Signature Required:

I, the undersigned, hereby state and affirm the following:

- If I subsequently hire anyone outside my immediate family, whether compensated or not, I am responsible to see that this individual or entity is registered as a contractor with the Willowick Building Department. If I keep the permit in my name, I am considered the "General Contractor" and retain full responsibility for the work performed.
- If I receive uncompensated help from my immediate family for this project and damages are incurred either to property or person, I take full responsibility for the work performed.
- I understand that all interior plumbing work requires a permit from the Lake County Health Department and the work is to be inspected and approved by the same; and that plumbing contractors must be registered with the Willowick Building Department.
- 751.99 PENALTY. Any person or contractor who performs or authorizes the performance of work in the City without first complying with the provisions of this chapter shall be fined not more than five hundred dollars (\$500.00) or imprisoned not more than thirty days, or both.

\_\_\_\_\_  
Applicant's Signature

\_\_\_\_\_  
Date

# Sample Site Plan

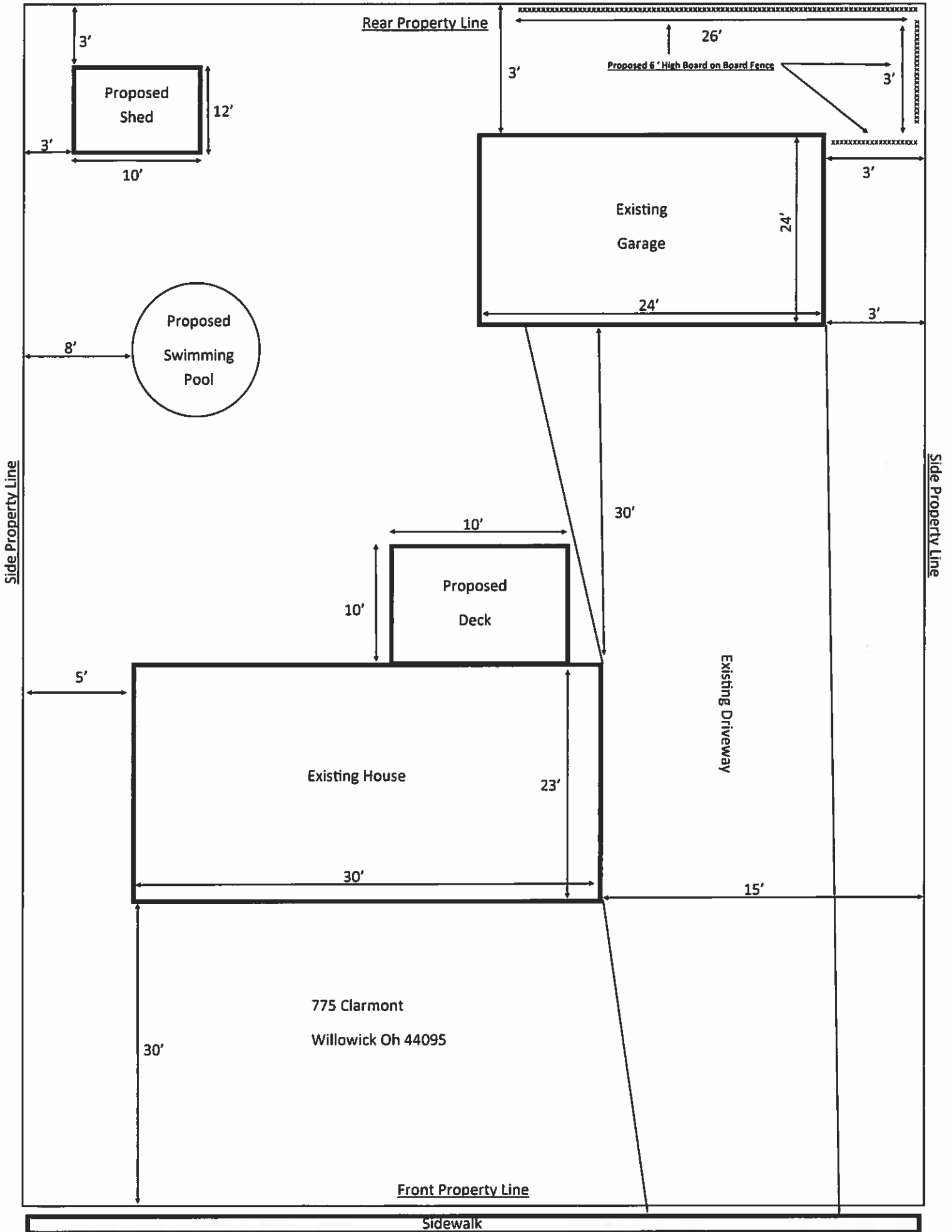

Date: \_\_\_\_\_

**REGIONAL INCOME TAX AGENCY**

Contractors Name: \_\_\_\_\_

Bldg Permit #: \_\_\_\_\_

Building Dept Registration of Contractors

Address: \_\_\_\_\_

Amt of Contract: \_\_\_\_\_

(To be Submitted with Application of Building Permit)

City: \_\_\_\_\_

Receipt #: \_\_\_\_\_

**MUNICIPAL INCOME TAX**

Fed ID# or Soc Secur #: \_\_\_\_\_

Job Location: \_\_\_\_\_

CITY OF WILLOWICK

Type	Contractor	Address:	SSN# or Fed ID#	Contract Amt	Estimated Wages:
Carpentry				\$	\$
Masonry				\$	\$
Excavation				\$	\$
Septic Tank or Sewer				\$	\$
Hot Roofing				\$	\$
Plumbing				\$	\$
Sheet Metal				\$	\$
Electrical				\$	\$
Refrigeration				\$	\$
Air Conditioning				\$	\$
Warm Air Heating				\$	\$
Steam Vapor				\$	\$
Hot Water				\$	\$
Dry Wall or Plastering				\$	\$
Demolition				\$	\$
Landscaping				\$	\$
Painting & Decorating				\$	\$
Other				\$	\$
			Total	\$	\$

## CHAPTER 1339

### Swimming and Wading Pools

---

- 1339.01 Definitions.
- 1339.02 Construction permit and approval.
- 1339.03 Permit fees.
- 1339.04 Inspection.
- 1339.05 Compliance with requirements of State Department of Health.
- 1339.06 Safety of bathers.
- 1339.07 Polluted water.
- 1339.08 Shielding lights.
- 1339.09 Unnecessary noise.
- 1339.10 Commercial activities.
- 1339.11 Enclosure of swimming pool.
- 1339.12 Districts where public pools permitted.
- 1339.13 Plans, specifications and data for family pools.
- 1339.15 Operation and maintenance.
- 1339.16 Permanent family wading pools.
- 1339.99 Penalty.

#### **CROSS REFERENCES**

Disturbing the peace - See GEN. OFF. 509.02

Plumbing, sewer and wiring permit fees - see BLDG. 1337.01

#### **1339.01 DEFINITIONS.**

As used in this chapter:

(a) "Inspector" means the Building Inspector of the City or his authorized representative.

(b) "Swimming pool for multiple dwelling units" means an artificial body of water with a controlled water supply over twelve inches in depth or 100 square feet of surface area, and used and intended to be used solely by the multiple dwelling residents and by friends invited to use it without payment of any fee.

(c) "Family swimming pool" means an artificial body of water, with a controlled water supply, over twenty-four inches in depth or 200 square feet of surface area, and used or intended to be used solely by the owner or lessee thereof and his family and by friends invited to use it without payment of any fee.

(d) "Public swimming pool" means an artificial body of water with a controlled water supply, used collectively by numbers of persons for swimming or recreative bathing to which the public is not excluded.

(e) "Public wading pool" means an artificial body of water, with a controlled water supply, not exceeding twenty-four inches in depth and used collectively by numbers of persons for wading.

(f) "Permanent family wading pool" means a container which is designed or used for wading purposes, built either upon or below the level of the ground, which is not designed or intended to be readily dismantled,, stored or moved from one place to another.

(g) "Private and club swimming pool" means an artificial body of water with a controlled water supply used collectively by numbers of persons for swimming or recreative bathing and where such persons are members of the club or association, or a number of private families, and where the public is otherwise excluded.

(h) "Board of Health" means the Board of Health of the Lake County General Health District or its duly authorized successor agency or official.

(i) "Director of Public Safety" means the Director of Public Safety of the City or any person to whom he may assign any function vested in him under this chapter.

(Ord. 61-71. Passed 6-21-61. )

### **1339.02 CONSTRUCTION PERMIT AND APPROVAL.**

Before work is commenced on the construction of a public swimming pool, family pool, public wading pool or on any alteration, addition, remodeling or other improvement thereto, an application for a permit to construct, and the plans and specifications and pertinent explanatory data hereinafter required, shall be submitted to the Building Inspector for approval, and no part of the work shall be commenced until the Inspector has evidenced his approval by a suitable endorsement upon such plans and specifications, and has granted a permit therefor.

(Ord. 61-71. Passed 6-21-61.)

### **1339.03 PERMIT FEES.**

The fee for the building permit to construct a swimming pool shall be at the rate of seventy-five cents (\$0.75) per 100 square feet, or fraction thereof, of the ground area, occupied by the pool structure, with a minimum fee of ten dollars (\$10.00), except that the minimum fee for a portable family swimming pool which has a surface area of 400 square feet or less shall be one dollar (\$1.00). The fee for the building permit to alter, arid to or remodel a swimming pool or to construct a permanent wading pool shall be five dollars (\$5.00). Such fee is in addition to permit fees applicable to other structures which may be incidental to the pool, or plumbing, sewer, fence or wiring connections therewith.

(Ord. 04-29. Passed 7-1-64.)

### **1339.04 INSPECTION.**

The Board of Health or Director of Public Safety shall inspect or cause to be inspected all pools within the City at such times as it may deem necessary to carry out the intent of this chapter. The Board or the Director is hereby authorized to enter upon any premises, private or public, to take such samples of water from such pools at such times as it may deem necessary and to require the owner, proprietor or operator to comply with the provisions of this chapter. 1n the event of the failure of compliance, after due notice, with any provision of this chapter, the Board or the Director shall have the power to abate or cause a suspension of the use of such pool until such time as the same is, in the opinion of the Board or the Director, no longer a menace or a hazard to health, safety or morals.

(Ord. 61-71. Passed 6-21-61.)

#### **1339.05 COMPLIANCE WITH REQUIREMENTS OF STATE DEPARTMENT OF HEALTH.**

In the construction, operation and maintenance of any swimming pool, laws of the State and the rules, regulations and requirements of the State Department of Health shall be observed. In the event of any conflict between the provisions of this chapter and any provision of State law or requirement, rule or regulation of the State Department of Public Health, the provision imposing the higher standard or the more stringent requirement shall be controlling.

(Ord. 61-71, Passed 6-21-61.)

#### **1339.06 SAFETY OF BATHERS.**

All reasonable precautions shall be taken to protect the users of public and family swimming pools from injury or accident. Convenient means of ingress and egress shall be provided and the depth of water and any irregularities of the bottom shall be clearly indicated. Safety appliances such as lifebuoys, life hooks, bamboo poles or ropes and equipment including first-aid kits shall be provided and be readily accessible.

(Ord. 61-71. Passed 6-21-61.)

#### **1339.07 POLLUTED WATER.**

No constructed pool or artificial body of water in the City which contains sewage, waste or other contaminating or polluting ingredients rendering the water hazardous to health, and no body of water which fails to meet the requirements of this chapter, shall be used for swimming or bathing purposes by any person.

(Ord. 61-71. Passed 6-21-61.)

#### **1339.08 SHIELDING LIGHTS.**

Lights used to illuminate any pool shall be so arranged and shaded as to reflect light away from adjoining premises and public streets.

(Ord. 61-71. Passed 6-21-61.)

#### **1339.09 UNNECESSARY NOISE.**

No person shall make, continue or cause to be made or continued at any pool, any loud, unnecessary or unusual noise or any noise which annoys, disturbs, injures or endangers the comfort, repose, health, peace or safety of others. In the operation of a pool, no person shall use or permit the use or operation of any radio, receiving set, musical instrument, phonograph or other machine or device for the producing or reproducing of sound in such manner as to disturb the peace, quiet and comfort of the neighboring inhabitants, or at any time with louder volume than is necessary for convenient hearing of the person or persons who are in the pool premises.

(Ord. 61-71. Passed 6-21-61.)

#### **1339.10 COMMERCIAL ACTIVITIES.**

The carrying on of any commercial undertaking entailing sales of food, drinks or other merchandise within the enclosure of any public swimming pool as required in Section 1339.11, or on any private premises, is prohibited.

(Ord. 61-71. Passed 6-21-61.)

### **1339.11 ENCLOSURE OF SWIMMING POOL.**

Except for pools built substantially above existing grade level and which have above- grade sidewalls no less than four feet in height together with a deck at the top edge of the pool which is surrounded by an outer edge protective railing and which is fitted with an access ladder which can be lifted and locked in position to form an enclosed area in conjunction with the protective railing or which access ladder can be entirely removed and a gate or door be closed and locked to form an enclosed area with the protective railing (herein called "aboveground swimming pools"), every outdoor swimming pool shall be completely surrounded by a fence not less than six feet in height from the existing grade line for public swimming pools, and not less than four feet an height from the existing grade line for family swimming pools. The fence shall be constructed in accordance with the provisions of Part Eleven - The Planning and Zoning Code. A building or existing wall may be used as part of such enclosure.

All gates or doors opening through such fence enclosure shall be designed to permit locking and shall be kept locked when the pool is not in actual use, or is left unattended.

All aboveground swimming pools shall be designed to contain a protective railing at the outer edge of the deck which railing shall be not less than three feet in height and so that the access ladder may be lifted anal locked in position to form an enclosed area in conjunction with the railing or be capable of being removed and be fitted with a gate or door across the access space which is capable of being locked to form an enclosed area in conjunction with the railing. When the pool is not in actual use or is left unattended, the access ladder shall either be lifted and locked in position to form an enclosed area, or be moved and a gate or door to close the opening through the protective railing shall be put in place and locked.

The requirements for fencing and gates or lift or movable access ladders on aboveground pools shall apply to both new and existing outdoor swimming pools having a maximum depth over twenty-four inches, except that owners of existing outdoor pools shall be given a reasonable period, not to exceed six months from the effective date of this section (Ordinance 67-26, passed April 19, 1967) in which to comply. No person in possession of land within the City, either as owner, purchaser, lessee, tenant or a licensee, upon which is situated a swimming pool having a maximum depth over twenty-four inches shall fail to provide and maintain such fence or wall or liftable or removable access ladder as herein provided.

The Board of Zoning Appeals may make modifications in individual cases, upon a showing of good cause with respect to the height, nature or location of the fence, gates or latches, or the necessity therefor, provided the protection as sought hereunder is not reduced thereby. The Inspector of Buildings may permit other protective devices or structures to be used as long as the degree of protection afforded by the substitute devices or structures is not less than the protection afforded by the wall, fence, gate and latch described herein.

(Ord. 67-26. Passed 4-19-67.)

### **1339.12 DISTRICTS WHERE PUBLIC POOLS PERMITTED.**

Public swimming pools and public wading pools are permitted in Retail Use Districts only, as defined in the Zoning Code, upon a special use permit authorized by Council. Council shall authorize such use only upon being satisfied that the noise anal other factors incident to such pools will not adversely affect the use of surrounding property. Off-street parking shall be provided.

(Ord. 61-71. Passed 6-21-61.)

### **1339.13 PLANS, SPECIFICATIONS AND DATA FOR FAMILY POOLS.**

Plans, specifications and pertinent explanatory data required to be submitted in connection with an application for a permit to construct a family swimming pool or any alteration, addition, remodeling or



other improvements thereto shall comply with the following requirements, and shall include the following plans and information, as well as such other data as may reasonably be requested by the Building Inspector:

(a) Plans shall be drawn to a scale of not less than one-eighth inch per foot, indicating all materials and methods of construction and indicating all dimensions, including the length, width and depth of the pool and width of the pool deck;

(b) A profile plan showing the same information;

(c) A "rear yard" is the main yard across the full width of the lot between the rear line of the main building and the rear lot line. The depth of the rear yard is the mean distance between these two lines.

(d) No pool shall be constructed, installed or erected in front of any building setback line nor shall it occupy an area greater than ten percent of the lot area and be not closer than eight feet to any lot side line or rear line. No deck walk area shall be allowed within three feet of any property line, or within twenty feet of an adjacent dwelling.

(e) The pool equipment layout, showing filters, pumps, chlorinators, hair and lint interceptors and their location and other pertinent information;

(f) The liquid capacity of the pool;

(g) The liquid capacity of an accessory wading pool, if any;

(h) The kind, number and size of filters, including the square footage of the filter area in each unit;

(i) Top capacity in gallons per minute;

(j) The method of chlorination to be used;

(k) The type, design and location of enclosing fence, or, in the case of aboveground swimming pools, the type, design and location of the access ladder, protective railing and walkway deck.

(l) Description and plan of lighting facilities.

(Ord. 67-26. Passed 4-19-67. )

#### **1339.14 DESIGN AND CONSTRUCTION REQUIREMENTS FOR FAMILY POOLS.**

The Building Inspector shall, not issue a permit to construct any family swimming pool or any alteration, addition, remodeling or other improvement thereto unless the following design and construction requirements are observed. Family swimming pools shall be constructed and maintained in conformity with the following requirements. For pools already in existence, the Inspector shall furnish the owners with a program of improvements and additions which shall be carried out over a period not to exceed five years after notice, in order to comply with the requirements of this chapter, except for fencing, which shall be provided within six months from the effective date of this section (Ordinance 67-26, passed April 19, 1967).

(a) Material. The water containing surface of artificial pools shall be light in color, impervious and provide a tight tank with smooth and easily cleaned surfaces. Exposed sand or dirt bottoms are prohibited.

(b) Water Supply and Outlets. Each pool shall be equipped with water inlets and outlets of sufficient size and proper location to provide a uniform circulation of water in all parts of the pool. All water inlets shall be located not less than one foot above the flood rim of the pool, or shall be provided with a vacuum brake sufficient in size to prevent backflow in the event of lowered pressure in the public water lines. All drainage of the pool shall be into a storm outlet only.

(c) Walkways. Except in the case of aboveground pools described in Section 1339.11, the pool shall be completely surrounded by a walkway at least three feet in width which shall be drained away from the pool. Aboveground pools shall be completely surrounded by a deck at least two feet in width.

(d) Water in Pool. The water in the pool shall meet the requirements of the Board of Health.

(e) Recirculation. For new pools provision shall be made for complete circulation of water through all parts of the pool. The system shall be equipped with a water recirculating system of sufficient capacity to provide a complete turnover of water at least once in twenty-four hours. The installation of new pools of the "fill and draw" type shall not be permitted. A satisfactory recirculating system for the pool shall be installed consisting of circulating pumps, float valve control on water supply, if make up tank is used, hair and lint catcher, piping connections to inlets and outlets, and all other necessary fixtures and connections. All equipment must be readily accessible and every pool shall be provided with necessary equipment for the measurement of acidity or alkalinity and for residual determinations.

(f) Hair and Lint Catcher. The pump suction line of the recirculating system shall be provided with a hair and lint catcher.

(g) Hose. Hose connections and hose must be of ample size and pressure to clean all of the pool area.

(h) Lighting. Where a family pool is used during the hours of darkness, illumination of the pool surface and for a distance of eight feet from the edge of the pool shall be maintained between the limits of two and five candles of light, approximately one-half watt per square foot of the area required to be illuminated, where lights are placed not over ten feet above and within the limits of the area. All lighting and wiring shall be in accordance with the National Electrical Code, the 1971 edition, and all fixtures and equipment shall be UL approved.

(Ord. 67-28. Passed 4-19-67.)

### **1339.15 OPERATION AND MAINTENANCE.**

(a) Chlorination. Chlorination shall be accomplished in such manner that the amount of excess or residual chlorine in all parts of the pool at all times when the pool is in use shall not be less than four-tenths parts per million, nor more than one part per million.

(b) Quality of Water. The bacterial quality of water in the pool shall be maintained so that no two successive samples nor more than fifteen percent of any number of successive samples shall contain more than two hundred bacteria per cubic centimeter, nor show positive confirmed results for coli aerogenes.

(c) Testing.

(1) The Director of Public Safety or the Board of Health may require samples to be taken and submitted for test whenever it is considered necessary for the safe operation of any pool.

(2) Each family swimming pool shall be operated under the supervision of a responsible adult, capable of making field tests such as residual chlorine, and thoroughly familiar with the operation of all mechanical appurtenances of the pool. Any such operator shall, upon request, demonstrate to the satisfaction of the Building Inspector, his ability to perform his required duties.

(Ord. 61-71. Passed 6-21-61.)

### **1339.16 PERMANENT FAMILY WADING POOLS.**

(a) Materials. The water containing surface of a permanent wading pool shall be light in color, impervious and provide a tight tank with smooth and easily cleaned surfaces. Sand or dirt bottoms are prohibited.

(b) Water Supply and Outlets. Each permanent wading pool shall be provided with a trapped outlet to the storm drain. Water for the pool shall be from the City water supply.

(Ord. 61-71. Passed 6-21-61.)

**1339.99 PENALTY.**

Whoever violates any of the provisions of this chapter shall be fined not more than one hundred dollars (\$100.00).

A separate offense shall be deemed committed each day during or on which a violation occurs or continues.

(Ord. 61-71. Passed 6-21-61.)

## Residential Electrical Swimming Pool Information

This is not an all inclusive list of all of the requirements of the 2011 National Electrical Code (NEC) Article 680. However, the following information is a basic overview of some of the key points of Article 680. Installations shall comply with all of the requirements of the 2011 NEC.

**ARTICLE 680 DEFINITION- Permanently Installed Swimming Pools**-those that are constructed in the ground or partially in the ground, and all others capable of holding water in a depth greater than 42", and all pools installed inside a building, regardless of water depth, whether or not served by electrical circuits of any nature, is considered a permanent pool, and shall comply with Article 680 in the 2011 NEC.

### General Requirements:

1. Placement of installation of pools shall maintain clearances from overhead conductors, communication cables, and underground wiring. (Section 680.8, Table 680.8 and 680.10 of the 2011 NEC.)
2. NEC 300.5 - Branch circuits for pool-associated motors shall comply with this section for underground installations {UF cable not permitted see 680.21,(A)(1)}. Conductors installed underground in conduit shall be listed for wet locations.
3. NEC 680.21,(A)(1) The branch circuits for pool-associated motors shall be installed in rigid metal conduit, intermediate metal conduit, rigid polyvinyl chloride conduit, reinforced thermosetting resin conduit, or Type MC cable listed for the location. Other wiring methods and materials shall be permitted in specific locations or applications as covered in this section. Any wiring method employed shall contain an "insulated copper equipment grounding conductor" sized in accordance with 250.122 but not smaller than 12 AWG.
4. NEC 680.22,(A)(1) -Receptacles that provide power for water-pump motors or for other loads directly related to the circulation and sanitation system shall be located at least 10' from the inside walls of the pool, or not less than 6' from the inside walls of the pool if they meet the following conditions- (1) & (2) they shall be of the locking and the grounding type, (3) consist of a single receptacle, and (4) shall be protected by a ground-fault circuit interrupter.
5. NEC 680.22,(A)(3)-Where a permanently installed pool is installed at a dwelling unit(s), no fewer than one 125-volt,15-or 20-ampere receptacle on a general purpose branch circuit shall be located not less than 6' from, and not more than 20' from the inside wall of the pool. This receptacle shall not be located more than 6'-6" above the floor platform, or grade level serving the pool.
6. NEC 680.22,(A)(4) - All 15 and 20 ampere receptacles located within 20' of the inside walls of a pool shall be protected by a ground fault circuit interrupter. The receptacle shall be tamper resistant per section 406.12, and shall be listed as weather-resistant type per 406.9(A). Weather Proof Cover Required.
7. NEC 680.21,(C)-GFCI Protection-Outlets supplying pool pump motors connected to single-phase, 120 volt through 240 volt branch circuits, rated 15 or 20 amperes, whether by receptacle or by direct connection, shall be provided with ground-fault circuit-interrupter protection for personnel.

### Pool Bonding:

8. NEC 680.26,(B) Bonded Parts. The parts specified in 680.26(B)(1) through (B)(7) shall be bonded together using solid copper conductors, insulated covered, or bare, not smaller than 8 AWG or with rigid metal conduit of brass or other identified corrosion-resistant metal. Connections to bonded parts shall be made in accordance with 250.8. An 8 AWG or larger solid copper bonding conductor provided to reduce voltage gradients in the pool area shall not be required to be extended or attached to remote panelboards, service equipment, or electrodes.
9. NEC 680.26,(B)(2)-Perimeter Surfaces. The perimeter surface shall extend 3 feet horizontally beyond the inside walls of the pool and shall include unpaved surfaces as well as poured concrete surfaces and other types of paving. Perimeter surfaces less than 3 feet separated by a permanent wall or building 5 feet in height or more shall require equipotential bonding on the pool side of the permanent wall or building. Bonding to perimeter surfaces shall be provided as specified in 680.26,(B)(2)(a) or (2)(b) and shall be attached to the pool reinforcing steel or copper conductor grid at a minimum of four points uniformly spaced around the perimeter of the pool. For non-conductive pool shells, bonding at four points shall not be required. According to this section the bonding conductor (#8 AWG) shall be installed 18"- 24" from the inside walls of the pool, following the contour of the perimeter surface around the pool, and shall be attached to the pool or grid at a minimum of 4 points uniformly spaced. The conductor shall be secured within or underneath the perimeter surface 4"- 6" below the sub-grade. Only listed splices shall be permitted.
10. NEC 680.26,(C) -Pool Water - An intentional bond of a minimum conductive surface area of 9 inches squared shall be installed in contact with the pool water. This bond shall be permitted to consist of parts that are required to be bonded in 680.26(B).

# Swimming Pool (Typical Above Ground)

\* Utility Wires and other Overhead Conductors

\* Pools shall maintain clearances from overhead conductors at a height of 22.5' for 0-750V, 25' for 0-15KV, & 27' over 15-50KV from the top of the water level & 10' horizontally from the outside edges of the pool. Underground wiring shall not be permitted under the pool or within 5' horizontally from the inside wall of the pool unless the wiring is necessary to supply pool equipment. See # 1

Pool Water Bond- May use a bonded metal ladder, water pump nipple, skimmer bond kit, etc. See #10

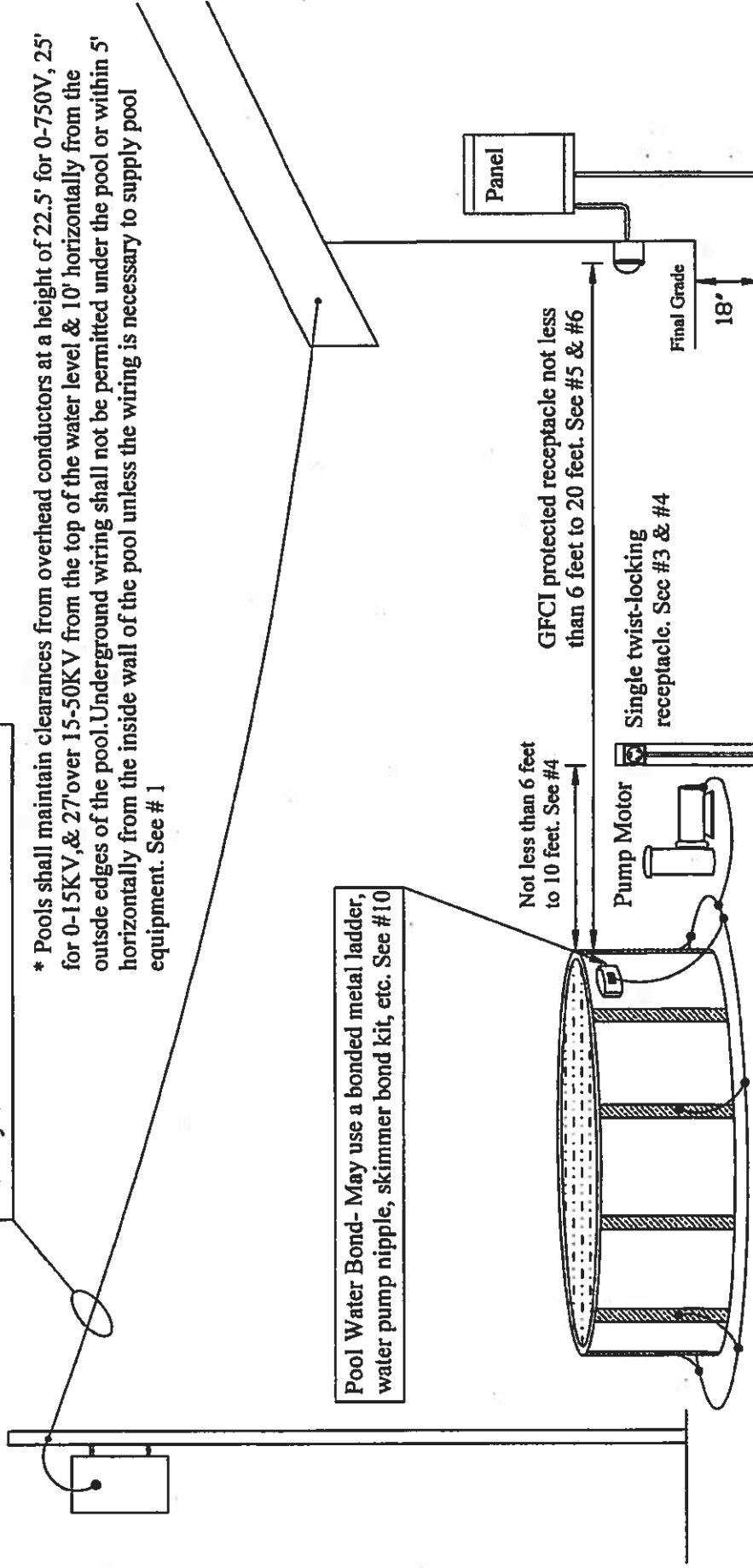

Not less than 6 feet to 10 feet. See #4

GFCI protected receptacle not less than 6 feet to 20 feet. See #5 & #6

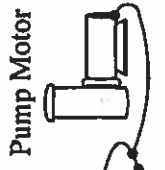

Single twist-locking receptacle. See #3 & #4

Final Grade

18'

Pool Bonding. #8 Solid Copper Conductor. See #8, #9 & #10

Schedule 40 PVC @ 18" below grade. GFCI Protected circuit conductors with "insulated copper equipment grounding conductor. (UF cable not permitted). See #2, #3, #4 & #7